

Lincolnton Plaza Shopping Center

1555 North Aspen Street, Lincolnton, NC 28092

1,500 to 7,000 square
foot suites available



For Lease: Call for Information



Proposed Renovation Design

Location

- This facility is under 2.0 mile access to US HWY 321, a four-lane divided, interstate quality highway.
 - 2.0 miles west of HWY 321
 - 27 miles east of I-77
 - 19 miles south of I-40
 - 16 miles north of I-85
 - 31 miles north of I-485
- 28 miles north of the Charlotte-Douglas International Airport (646 departures daily)
- 30 miles north of the uptown Charlotte

Property Overview

Available Spaces include End Cap Anchor, Retail and Former Restaurant

1,600 to 3,200 SF Retail Suites

6,000 SF/10,450 SF/19,460 SF Anchor & Junior Anchor suites available (April 2018)

Pricing: \$5.00-\$10.00/sq. ft., 1 year required/NNN

Outparcels Available- Call for Pricing

GENERAL INFORMATION:

Located at intersection of old Highway 321 Business and North Aspen St. on ±15.45 acres

- Ample Parking
- Signalized Access
- Along Lincolnton Retail Corridor
- Renovations to begin 2018

Infrastructure in Place

Water:	City of Lincoln County 12" Water Main
Sewer:	City of Lincolnton 8" Sewer Main
Electric:	Duke Energy
Natural Gas:	Piedmont Natural Gas 60 PSI 4" line
Data and Telecom: (Coax & Fiber)	Charter Communications and/or AT&T Communications

LEDA Contact Information:

Rhonda Hunter

Entrepreneur Specialist

Phone: (704) 732-1511 Ext. 1

Email Address: Rhonda@lincolneda.org



1555 North Aspen Street, Lincolnton, North Carolina 28092

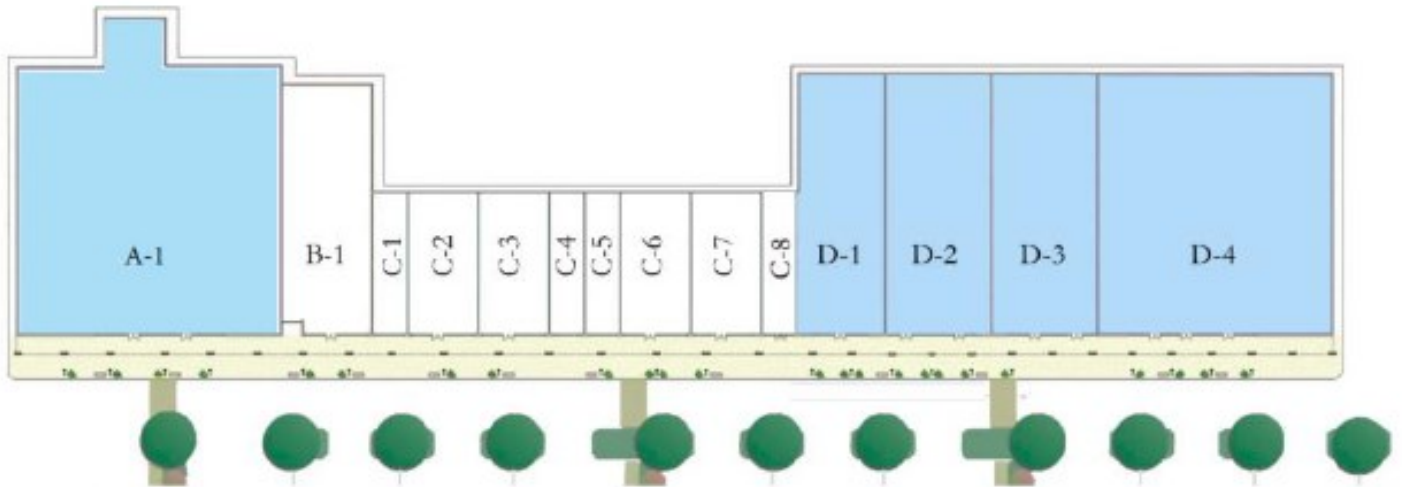

SUITE	TENANT	SF
A-1	Habitat for Humanity Restore	25,365
B-1	Vacant	7,088
C-1	Vacant	3,179
C-2	Vacant	1,667
C-3	Vacant	3,191
C-4	Vacant	1,627
C-5	Vacant	1,587
C-6	Vacant	3,180
C-7	Vacant	3,213
C-8	Studio 220 Salon	1,613
D-1	Bronze Body	6,091
D-2	Rock Fitness	10,450
D-3	Aarons	8,930
D-4	Kids Rock	19,406

Future Exterior Design of Lincolnton Plaza



7,000 sq. ft. All open and cleared ready of custom renovation

